

1.1	d_s	d_0	h_1
HZA (-R) M 12		Ø 16 mm	$l_{e, ges}$
HZA (-R) M 16		Ø 20 mm	
HZA (-R) M 20		Ø 25 mm	
HZA (-R) M 24		Ø 32 mm	
HZA M 27		Ø 35 mm	
HZA M 30		Ø 40 mm	
HZA M 39		Ø 55 mm	

1.2	d_s max.		
HIT-HY 150 MAX	HZA(-R) M12 ... M27	✓	✗
HIT-HY200 -A, -R -R V3	HZA(-R) M12 ... M30	✓	≥M16: ✓ + Hilti TE-YRT
HIT-CT 1	HZA(-R) M12 ... M24	✓	✗
HIT-RE 500 V3, V4	HZA M12 ... M27, HZA-R M12 ... M24	✓	✓
HIT-RE 100	HZA-R M12 ... M24	✓	✗

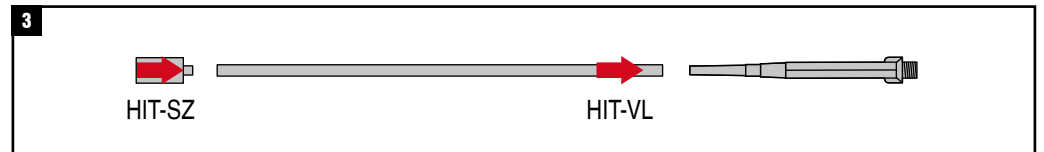

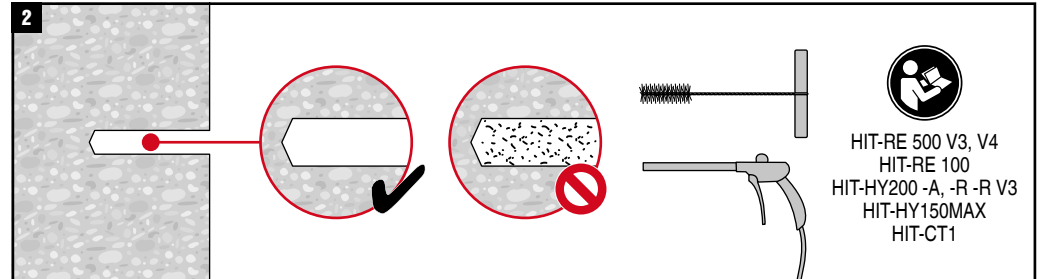
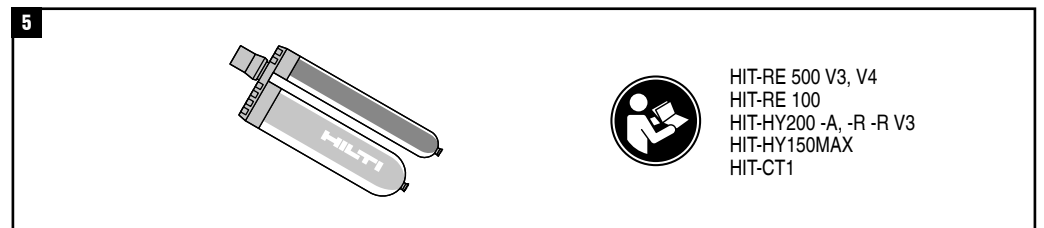
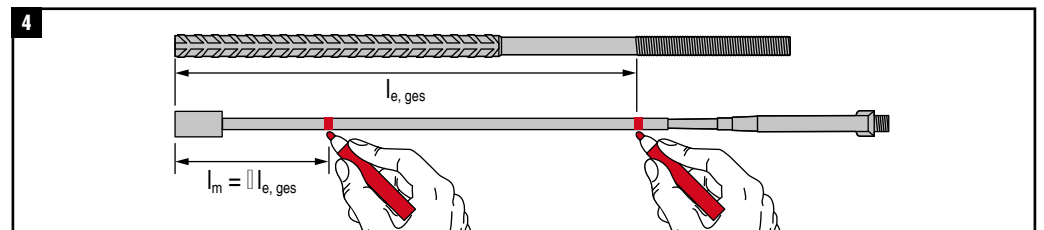

3.1	HIT-SZ	HIT-VL	HIT-RB
HZA (-R) M 12	HIT-SZ 16	HIT-VL 9/1.0	HIT-RB 16
HZA (-R) M 16	HIT-SZ 20	HIT-VL 16/0.7	HIT-RB 20
HZA (-R) M 20	HIT-SZ 25		HIT-RB 25
HZA (-R) M 24	HIT-SZ 32		HIT-RB 32
HZA M 27	HIT-SZ 35		HIT-RB 35
HZA M 30	HIT-SZ 40		HIT-RB 40
HZA M 39	HIT-SZ 55		HIT-RB 55

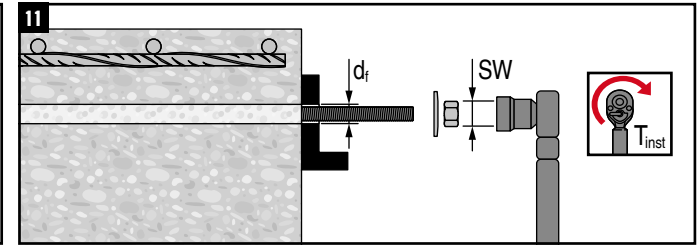
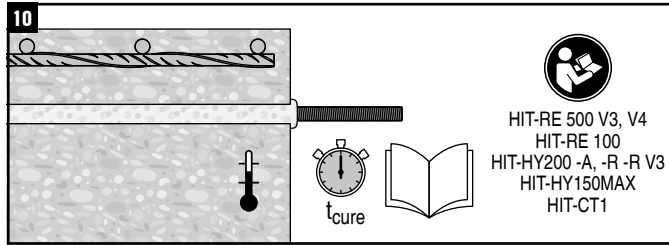
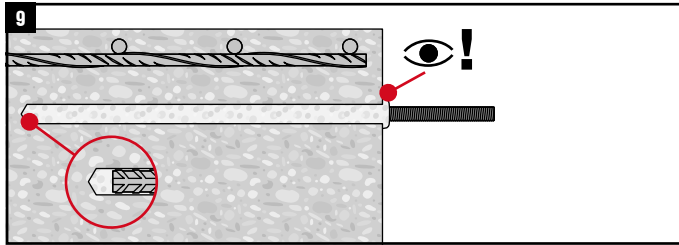
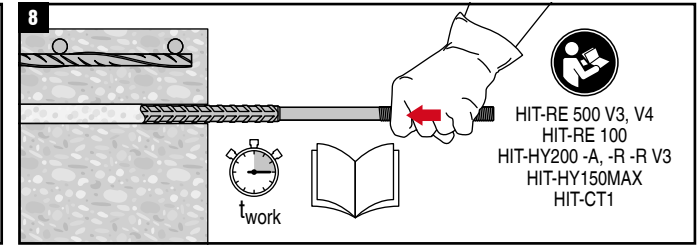
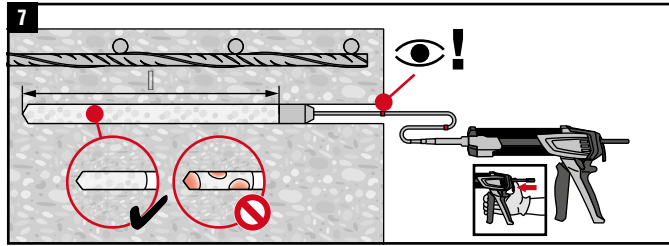
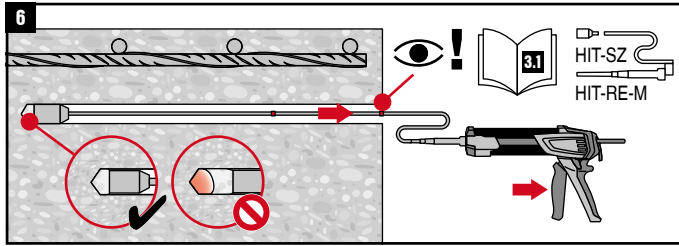

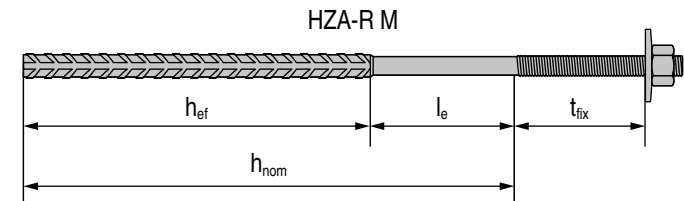

	①	②	③	④	option	h _{ef} l _e [mm]	M12		M16		M20		M24		M27	M30	M39	
							HZA	HZA-R	HZA	HZA-R	HZA	HZA-R	HZA	HZA-R	HZA	HZA	HZA	
HIT-HY 200-A	19	-10/07.14	11/0493	EAD 330499-01	1	h _{ef} l _e [mm]	70-220 20	70-140 100	80-300 20	80-220 100	90-380 20	90-300 100	100-480 20	100-400 100	120-540 20			
	14	-5/07.14	11/0492	ETAG 001-1, -5		l _v l _e [mm]		< 800 ≥ 100		< 1300 ≥ 100		< 1300 ≥ 100		< 1300 ≥ 100				
HIT-HY 200-R	19	-11/07.14	12/0084	EAD 330499-01	1	h _{ef} l _e [mm]	70-220 20	70-140 100	80-300 20	80-220 100	90-380 20	90-300 100	100-480 20	100-400 100	120-540 20			
	19	-6/07.14	12/0083	EAD 331522-00		l _v l _e [mm]	70-780 20	70-700 100	80-1280 20	80-1200 100	90-1280 20	90-1200 100	100-1280 20	100-1200 100	120-1280 20			
HIT-HY 200-R V3	19	-56/07.14	19/0601	EAD 330499-01	1	h _{ef} l _e [mm]	70-220 20	70-140 100	80-300 20	80-220 100	90-380 20	90-300 100	100-480 20	100-400 100	120-540 20			
	19	-55/07.14	19/0600	EAD 331522-00		l _v l _e [mm]	70-780 20	70-700 100	80-1280 20	80-1200 100	90-1280 20	90-1200 100	100-1280 20	100-1200 100	120-1280 20			
HIT-HY 200-A/-R	18	-42/07.14	18/0837	EAD 330499-00		h _{ef} l _e [mm]			80-300 20	80-220 100	90-380 20	90-300 100	100-480 20	100-400 100	120-540 20			
HIT-RE 100	19	-20/07.14	15/0882	EAD 330499-00		h _{ef} l _e [mm]		70-140 100		80-220 100		90-300 100		100-400 100				
HIT-RE 500 V3	19	-23/07.14	16/0143	EAD 330499-01	1	h _{ef} l _e [mm]	70-220 20	70-140 100	80-300 20	80-220 100	90-380 20	90-300 100	100-480 20	100-400 100	120-540 20			
	19	-22/07.14	16/0142	EAD 331522-00		l _v l _e [mm]	70-780 20	70-700 100	80-1280 20	80-1200 100	90-1280 20	90-1200 100	100-1280 20	100-1200 100	120-1280 20			
	18	-40/07.14	18/0745	EAD 332077-00		h _{ef} l _e [mm]	70-220 20	70-140 100	80-300 20	80-220 100	90-380 20	90-300 100	100-480 20	100-400 100	120-540 20			
HIT-CT 1	17	-29/07.14	11/0390	EAD 330087-00		h _{ef} l _e [mm]	70-780 20	70-700 100	80-1280 20	80-1200 100	90-1280 20	90-1200 100	100-1280 20	100-1200 100	120-1280 20			
						l _v l _e [mm]												
HIT-HY 150 MAX	18	-39/07.14	08/0202	EAD 330087-00		h _{ef} l _e [mm]		70-140 100		80-220 100		90-300 100		100-400 100				
	18	-38/07.14	38/07.14	EAD 330499-00		h _{ef} l _e [mm]		70-140 100		80-220 100		90-300 100		100-400 100				
HIT-RE 500 V4	21	67	20/0540	EAD 330087-01		l _v l _e [mm]	70-780 20	70-700 100	80-1280 20	80-1200 100	90-1280 20	90-1200 100	100-1280 20	100-1200 100	120-1280 20			
	21	66	20/0541	EAD 330499-01		h _{ef} l _e [mm]	70-220 20	70-140 100	80-300 20	80-220 100	90-380 20	90-300 100	100-480 20	100-400 100	120-540 20			



 d _s	d _i	SW	T _{inst}
HZA (-R) M 12	Ø 14 mm	19	0 ... 40 Nm
HZA (-R) M 16	Ø 18 mm	24	0 ... 80 Nm
HZA (-R) M 20	Ø 22 mm	30	0 ... 150 Nm
HZA (-R) M 24	Ø 26 mm	36	0 ... 200 Nm
HZA M 27	Ø 30 mm	41	0 ... 270 Nm
HZA M 30	Ø 33 mm	46	0 ... 300 Nm
HZA M 39	Ø 42 mm	60	0 ... 390 Nm

CE

Hilti AG
 FL-9494 Schaan
 Hilti Werke
 1343-CPR-M 500-...
 ETA-...
 Notified body 1343
 ...
 www.hilti.com

①
②
③
④