

HUS-CR 8	h_1	t_{fix}		
		$h_{nom1}=50\text{mm}$	$h_{nom2}=60\text{mm}$	$h_{nom3}=80\text{mm}$
8x65	$75\text{mm} - t_{fix}$	5...15mm	-	-
8x75	$85\text{mm} - t_{fix}$	16...25mm	5...15mm	-
8x95	$105\text{mm} - t_{fix}$	36...45mm	16...35mm	5...15mm

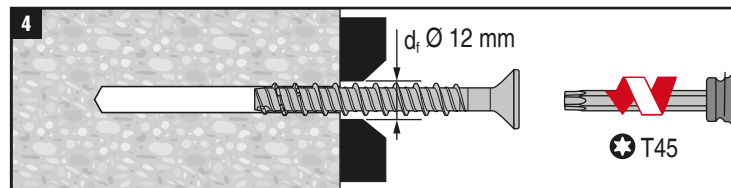

4.1		
	SIW 14-A	✓
	SIW 22-A	✓
	SIW 22T-A	✓
	T	≠
d_0		Ø 8mm

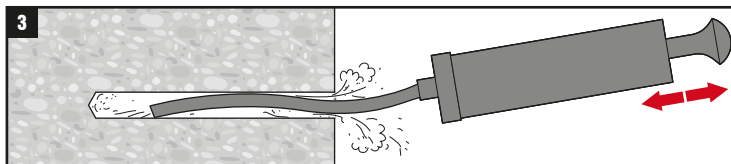

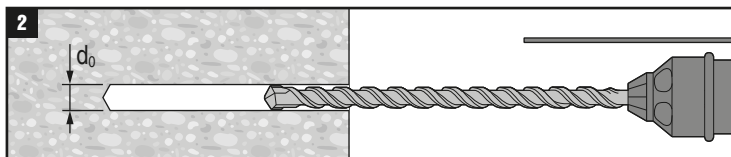
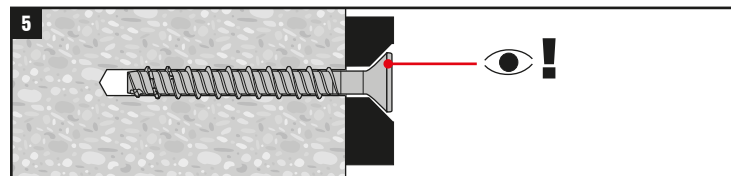
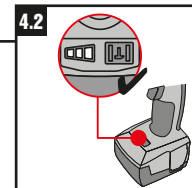
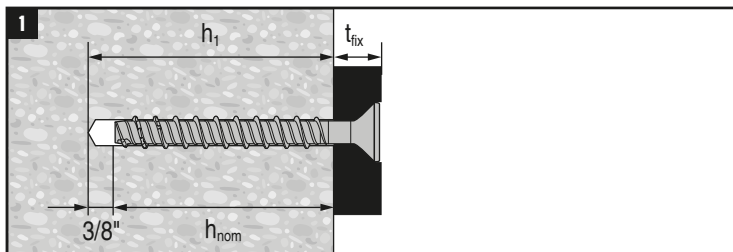

1.1 HUS-CR 8	h ₁	t _{fix}	
		h _{nom1} =2-3/8"	h _{nom2} =3-1/8"
8x65	2-15/16" - t _{fix}	3/16"	-
8x75	3-3/8" - t _{fix}	3/16"...9/16"	-
8x95	4-1/8" - t _{fix}	-	3/16"...9/16"

