

1.1	HUS-HR	h_1	t_{fix}
	10 x 95	$105 \text{ mm} - t_{fix}$	0 ... 5 mm
	10 x 105	$115 \text{ mm} - t_{fix}$	0 ... 15 mm
	10 x 115	$125 \text{ mm} - t_{fix}$	0 ... 25 mm
	10 x 130	$140 \text{ mm} - t_{fix}$	0 ... 40 mm

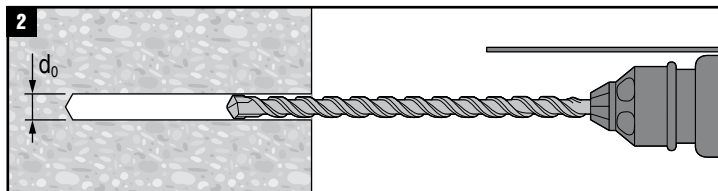

2.1			
	d_0	$\text{Ø } 10 \text{ mm}$	$\text{Ø } 8 \text{ mm}$

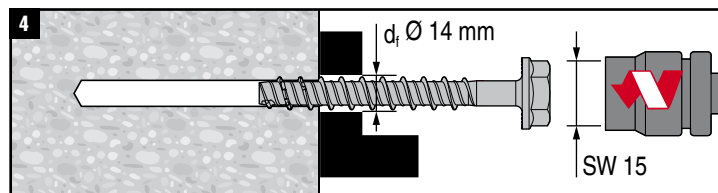
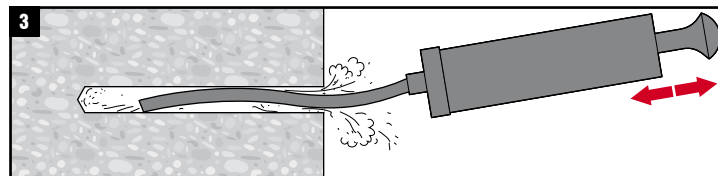

4.1			
	SIW 22-A	<input type="checkbox"/>	<input type="checkbox"/>
	SIW 22T-A	<input checked="" type="checkbox"/>	<input type="checkbox"/>
	SI 100	<input checked="" type="checkbox"/>	<input type="checkbox"/>
	45 Nm	20 Nm	10 Nm

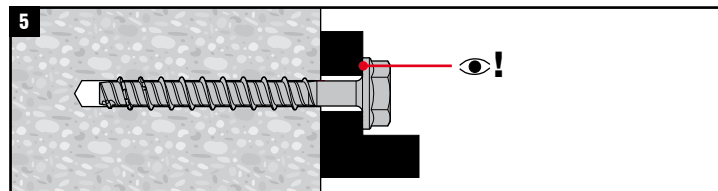

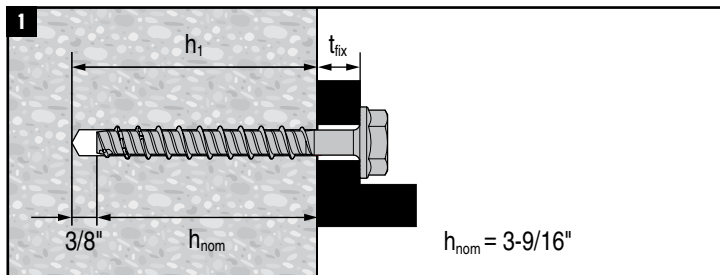

1.1

HUS-HR 10	h_1	t_{fix}
10 x 95	$4-1/8" - t_{fix}$	$0" \dots 3/16"$
10 x 105	$4-1/2" - t_{fix}$	$0" \dots 9/16"$
10 x 115	$4-15/16" - t_{fix}$	$0" \dots 1"$
10 x 130	$5-1/2" - t_{fix}$	$0" \dots 1-9/16"$

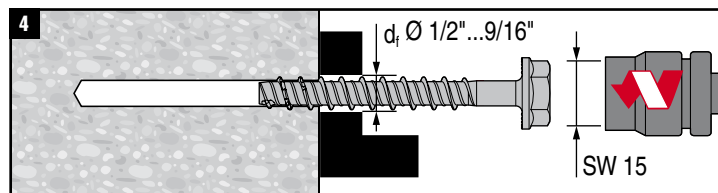
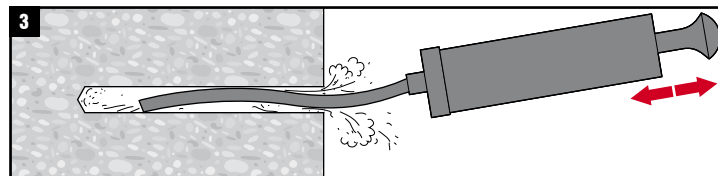
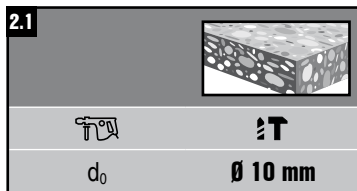
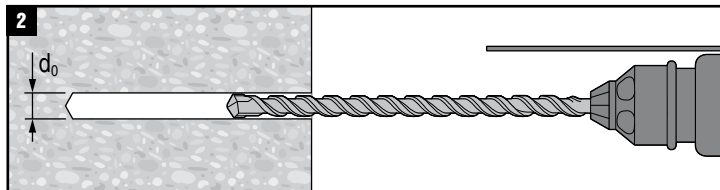

4.1

	SIW 22-A	✓
	SIW 22T-A	✓
	33 ft-lb	

