



DC-EX 125/5" M

English

1 Information about the documentation

1.1 About this documentation

- Read this documentation before initial operation or use. This is a prerequisite for safe, trouble-free handling and use of the product.
- Observe the safety instructions and warnings in this documentation and on the product.
- Always keep the operating instructions with the product and make sure that the operating instructions are with the product when it is given to other persons.

1.2 Explanation of symbols used

1.2.1 Warnings

Warnings alert persons to hazards that occur when handling or using the product. The following signal words are used:

DANGER

DANGER !

- Draws attention to imminent danger that will lead to serious personal injury or fatality.

WARNING

WARNING !

- Draws attention to a potential threat of danger that can lead to serious injury or fatality.





CAUTION

CAUTION !

- Draws attention to a potentially dangerous situation that could lead to slight personal injury or damage to the equipment or other property.





1.2.2 Symbols in the documentation

The following symbols are used in this document:

	Read the operating instructions before use.
	Instructions for use and other useful information
	Dealing with recyclable materials
	Do not dispose of electric equipment and batteries as household waste

1.2.3 Symbols in the illustrations



The following symbols are used in illustrations:

	These numbers refer to the corresponding illustrations found at the beginning of these operating instructions
	The numbering reflects the sequence of operations shown in the illustrations and may deviate from the steps described in the text
	Item reference numbers are used in the overview illustrations and refer to the numbers used in the product overview section
	This symbol is intended to draw special attention to certain points when handling the product.
	Wireless data transfer

1.3 Product-dependent symbols

1.3.1 Symbols

The following symbols are also used:

	Wear protective goggles while working with the tool.
	Wear ear protection while working with the tool.
	Wear protective gloves while working with the tool.

1.4 Product information

HILTI products are designed for professional users and only trained, authorized personnel are permitted to operate, service and maintain the products. This personnel must be specifically informed about the possible hazards. The product and its ancillary equipment can present hazards if used incorrectly by untrained personnel or if used not in accordance with the intended use.

The type designation and serial number are printed on the rating plate.

- ▶ Write down the serial number in the table below. You will be required to state the product details when contacting Hilti Service or your local Hilti organization to inquire about the product.

Product information

Hood	DC-EX 125/5"M
Generation:	01
Serial no.:	

2 Safety

2.1 Safety instructions

⚠ WARNING! Read all safety precautions and instructions in this documentation and the safety instructions of the approved tools. Failure to follow the safety instructions and other instructions can result in electric shock, fire and/or serious injury.

Keep all safety precautions and instructions for future reference.

- ▶ Wear personal protective equipment and always wear protective goggles.
- ▶ Use respiratory protection to keep residual dust away from the face and airways when working.
- ▶ Even when the hood is fitted, always use the side handle of the approved **Hilti** power tool.
- ▶ Wear protective gloves when changing the accessory tool.

3 Description

3.1 Product overview

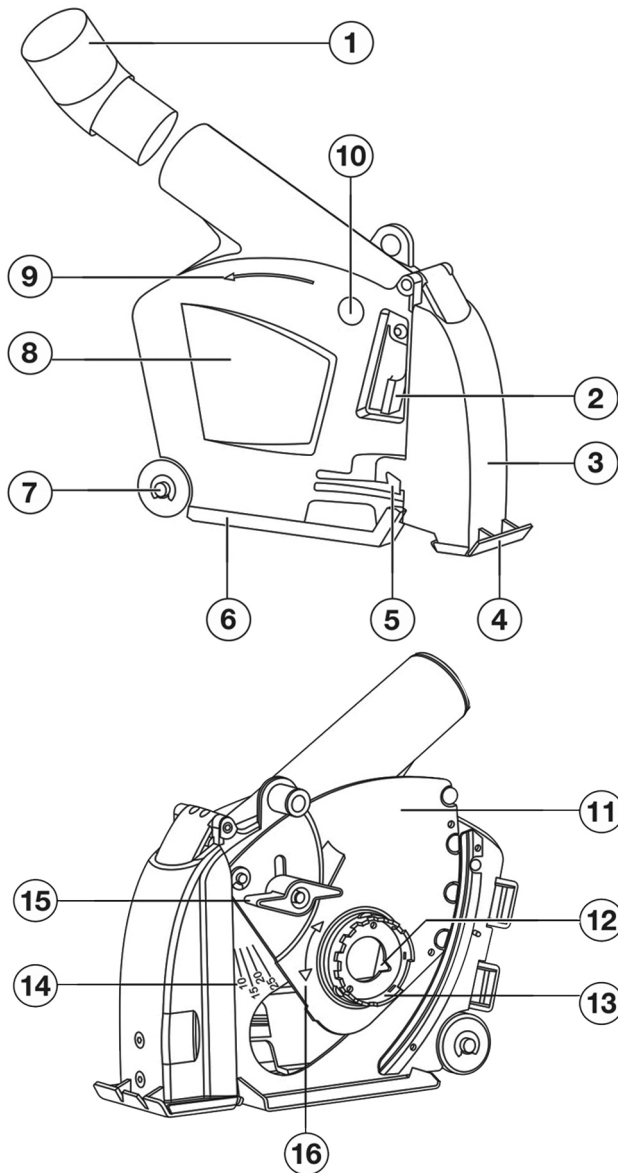

- ① Connector
- ② Locking catch
- ③ Front clip
- ④ Carriage plate with cutting line indicator

- ⑤ Catch
- ⑥ Carriage plate
- ⑦ Wheels
- ⑧ Cover

- | | | | |
|---|------------------------------|---|---|
| ⑨ | Direction-of-rotation arrow | ⑬ | Positioning mark for fitting to angle grinder |
| ⑩ | Side-handle attachment point | ⑭ | Depth gauge scale |
| ⑪ | Back panel | ⑮ | Locking screw |
| ⑫ | Carriage plate | ⑯ | Direction of rotation indicator for positioning the angle grinder |

3.2 Slitting adapter set

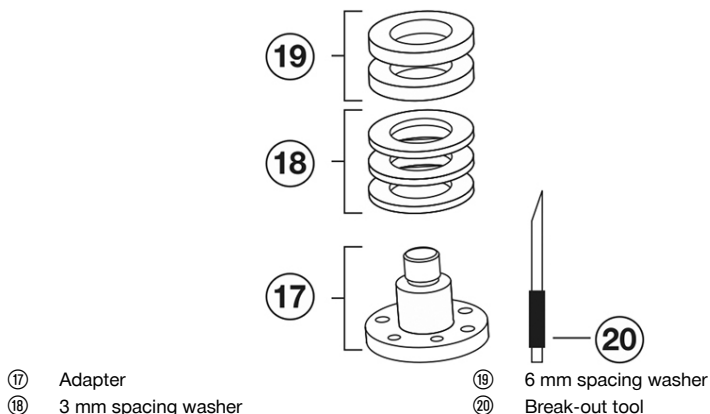

3.3 Intended use

The DC-EX 125/ 5" M slitting hood is for cutting and slitting mineral materials, particularly masonry, with 125 mm / 5" discs in combination with a **Hilti** dust extractor. Use the DC-EX 125/ 5" M slitting hood only for the AG 500 11S, AG500 13D, AG 125-13S and AG 125-19SE angle grinders and only without water.

3.4 Items supplied

1 spacing adapter, 3 spacing washers (3 mm / 0.1 in), 2 spacing washers (6 mm / 0.2 in), break-out tool for breaking out fillet

You can find other system products approved for your product at your local **Hilti** Center or online at: www.hilti.com.

4 Technical data

4.1 Technical data

	DC-EX 125/5"M
Weight	1.35 kg
Disc diameter	125 mm
Slitting width with twin discs	25 mm
Maximum cutting depth	28 mm

4.2 Diamond cutting discs

	Diamond cutting disc
Application	Cutting, slitting
Designation	DC-D
Material	Mineral

5 Before use

5.1 Fitting the hood

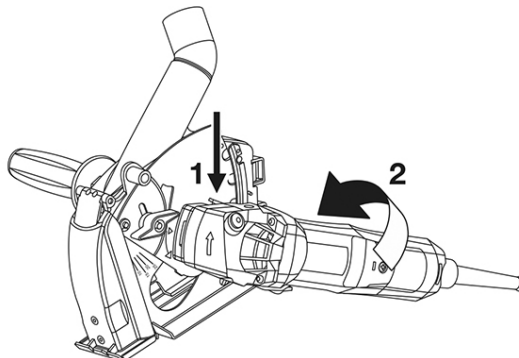

1. Fit the guard on to the arbor collar so that the two triangular marks on the guard and on the power tool are in alignment.
2. To bring the hood to the desired working position, pivot the device radially while pressing the catch on the angle grinder.
 - ◀ The catch engages with an audible click.

5.2 Opening hood

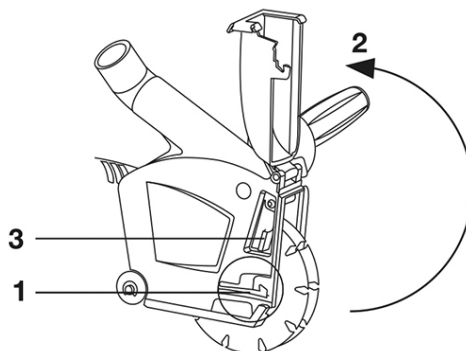

1. Press the catch.
2. Open the front clip.
3. Press the locking catch.
4. Open the hood.

5.3 Fitting the diamond cutting disc for slitting applications



The use of Kwick-Lock nuts for this application is not permitted.
For this application you need the slitting adapter set, which is additionally available.

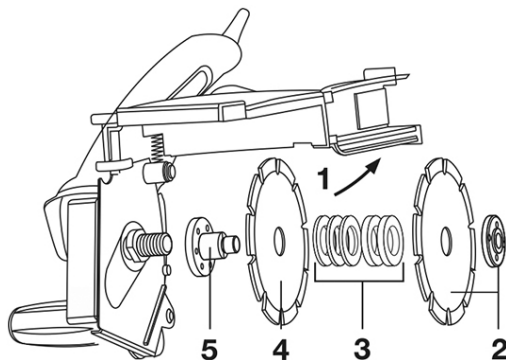

1. Remove the clamping flange for the arbor.
2. Screw the adapter on to the arbor and tighten it securely.
3. Insert a diamond cutting disc, observing the specified direction of rotation.
4. Fit the spacer rings for the desired width between slits.
5. Insert a diamond cutting disc, observing the specified direction of rotation.
6. Screw on the clamping nut and tighten it securely with the pin wrench.
7. Close the hood.

5.4 Fitting a diamond cutting disc

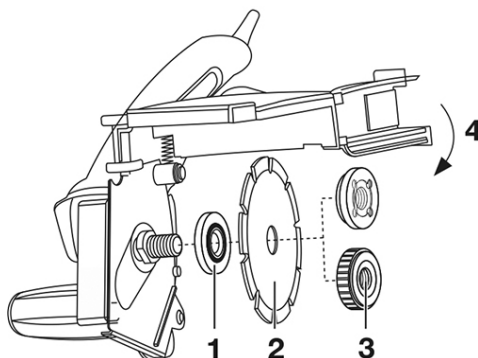

1. Fit the clamping flange on to the arbor.
2. Place the first diamond cutting disc on the clamping flange.



Observe the specified direction of rotation.

3. Screw on the **Kwick-Lock** nut until it is seated against the cutting disc.
4. Close the hood.

5.5 Setting depth

1. Release the locking screw.
2. Push the back panel to the desired position.
 - ◀ The scale shows the group.
3. Firmly tighten the locking screw.

5.6 Plunge function

1. Position the carriage plate on the work.
2. Switch on the tool.

3. Guide the cutting disc into the work.



You can disable the plunge function with the locking screw.

5.7 Fitting the side handle

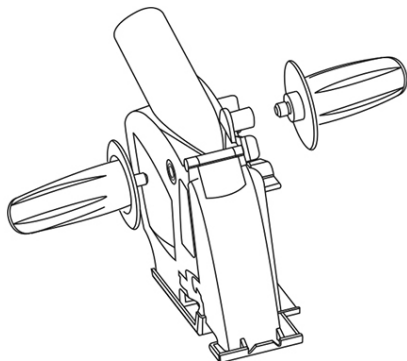

- Fit the side handle on the desired side.

6 Operation

6.1 Wall and corner accessibility

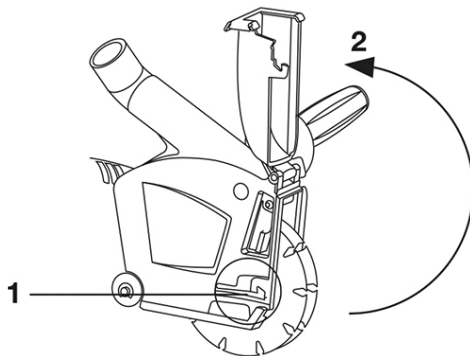

1. Press the locking catch.
2. Open the front clip more than 180 °.

6.2 Marks for cut positioning

Mark **1** indicates the position of the inner cutting disc or single disc, as applicable.
 Mark **2** indicates the maximum slitting width (max. position of the second disc).

6.3 Removing the accessory tool

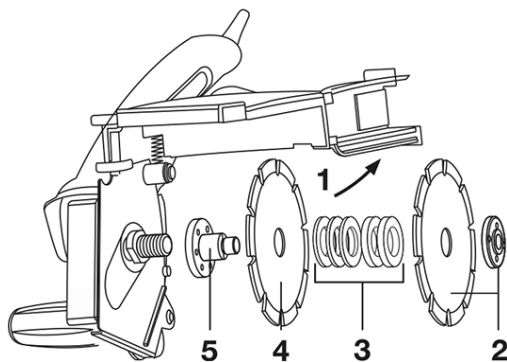

1. Open the hood. → page 5
2. Open the clamping nut.
3. Remove the diamond cutting disc.
4. Remove the spacer rings.
5. Remove the diamond cutting disc.
6. Use the pin wrench to release the adapter.
7. Press the catch on the angle grinder.
8. Turn the hood radially until it can be removed from the tool.

6.4 Breaking out the fillet

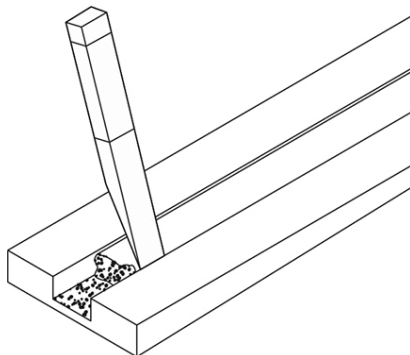

- Break out the fillet.

7 Manufacturer's warranty

- Please contact your local **Hilti** representative if you have questions about the warranty conditions.



Hilti Corporation
LI-9494 Schaan
Tel.: +423 234 21 11
Fax: +423 234 29 65
www.hilti.group



2164701



Hilti Connect